

RESIDENTIAL LIFT
MP|ARES MOBI

FEATURES

TYPE:	Hydraulic lift platform
LOAD:	180 kg to 630 kg
CAPACITY:	2 to 8 persons
SPEED:	0.15 m/s
TRAVEL RANGE:	Up to 18 m
ENTRANCES:	Single entrance, double 180° entrance, double 90° entrance and tripe entrance
SERIES:	"C" With machine room and "S" machine room less

CAR

MODEL:	D-100 with single beam photocell (Optional: curtain photocell)
	Jamb arrow direction (Optional: other car models, see catalogues)
EXTERIOR DIMENSIONS:	See table
HEIGHT:	2100 mm (Optional: other heights)

CAR DOORS

TYPE:	Automatic: 2 side-opening panels. 3VF (Optional: other models)
FINISH:	Stainless steel (X02)
DIMENSIONS:	Ver tabla x 2000 mm (Optional: other heights)

LANDING DOORS

TYPE:	Automatic: 2 side-opening panels (Optional: other models)
FINISH:	Epoxy RAL 7044 (Optional: Stainless steelX02)
DIMENSIONS:	See table x 2000 mm (Optional: other heights)
FIRE RESISTANCE CLASSIFICATION:	E120, EW60 according to EN 81-58 (Optional: other classifications)

SHAFT

DIMENSIONS:	See table
PIT:	See table
HEADROOM:	See table

CAR OPERATING PANEL

MODEL:	Plate
FINISH:	Plastic-coated steel (Optional: Stainless steel X02)
PUHSBUTTON:	Mechanical, polycarbonate plastic, fireproof pushbutton lit using Leds (Optional: Mechanical, stainless steel pushbutton with halo lighting)
CAR INDICATOR:	Display made up of 2 digits with Leds of 7 segments (Opcional: Display LCD)
SAFETY:	Emergency light and telephone

LANDING OPERATING PANEL

MODEL:	P001, on the door frame
FINISH:	Stainless steel plate (X02)
PUHSBUTTON:	Mechanical, polycarbonate plastic, fireproof pushbutton lit up with Leds (Optional: Mechanical, stainless steel pushbutton with halo lighting)
ENGRAVING:	Black logo (done with laser)

CONTROLLER

TYPE:	Microbasic controller. Down collective or pick-up
LOCATION:	In the machine room for "C" series. It may be placed anywhere within the machine room In the cabinet for "S" series. Epoxy finish. Recommended distance < 10 metres

ELECTRICAL INSTALLATION

	Premontada con conectores "Plug & Play"
--	---

HYDRAULIC POWER UNIT

	Motor Manometer-Thermistor. Thermal oil contact
	Electromechanical valve block MP sava3
	Manual pump. Oil
	Automatic rescue

JACK

	In 1 section up to 9800 mm of travel range, in 2 sections from 9800 mm
--	--

BUFFERS

	Made from polyurethane with a metal pedestal included
--	---

GUIDE RAILS

	rawn in accordance with ISO 7465
--	----------------------------------

FIXINGS

	Fixing brackets and plugs for concrete enclosure
--	--

ELECTRICAL FEATURES

POWER SUPPLY VOLTAGE:	380 V three-phase
LIGHTING VOLTAGE:	220 V
FREQUENCY:	50 Hz

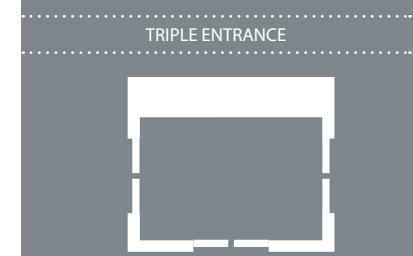
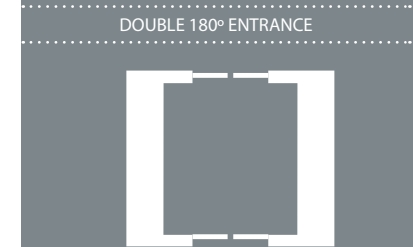
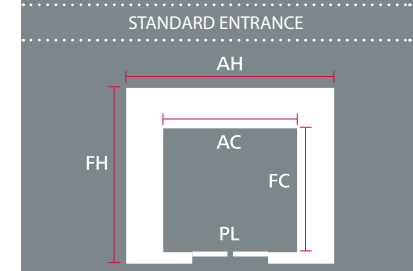
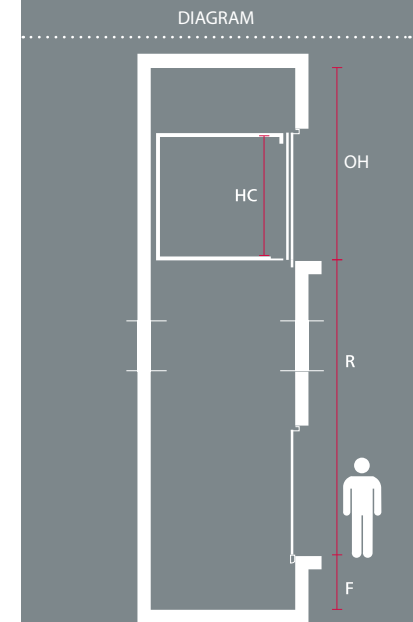

NOTE: Specifications corresponding to the basic rate model



Hydraulic



2 to 8 persons



180 to 360 kg



With machine room and machine room less

	S and C SERIES ⁽¹⁾					
	MP ARES MOBI S	MP ARES MOBI M	MP ARES MOBI L	MP ARES MOBI XL	MP ARES MOBI 2XL	MP ARES MOBI 4XL
Capacity (persons)	2	3	4	5	6	8
Speed (m/s)	0,15	0,15	0,15	0,15	0,15	0,15
Starts per hour	15	15	15	15	15	15
Power (HP/ kW)	2.7 / 2	2.7 / 2	2.7 / 2	4 / 3	4 / 3	4 / 3
Current (A) ⁽²⁾	5,6	5,6	5,6	10	10	10
Q capacity (kg)	180	225	320	375	480	630
PL clear opening (mm)	600	700	700	800	800	800
AC car width (mm)	700	800	1000	1000	1000	1100
FC car depth (mm)	800	900	900	1100	1250	1400
HC useful internal car height (mm)	2100	2100	2100	2100	2100	2100
AH shaft width (mm)	1060	1160	1400	1360	1400	1500
FH shaft depth (mm)	1075	1100	1200	1360	1550	1700
F minimum pit (mm) ⁽³⁾	150 / 645 / 875 / 1004	150 / 645 / 875 / 1004	150 / 645 / 875 / 1004	150 / 645 / 875 / 1004	150 / 645 / NA / 1004	150 / 645 / NA / 1004
OH minimum headroom (mm) ⁽³⁾	2390 / 2814 / 2860 / 3330	2390 / 2814 / 2860 / 3330	2390 / 2814 / 2860 / 3330	2390 / 2814 / 2860 / 3330	2390 / 2814 / NA / 3330	2390 / 2814 / NA / 3330
No. ropes x diameter (mm)	4 x 8	4 x 8	4 x 8	4 x 8	4 x 8	4 x 8
Jack: Number - Position	1 - side	1 - side	1 - side	1 - side	1 - side	1 - side
Max. distance between brackets	1500	1500	1500	1500	1500	1500
Car guide rails	T70 / 70 / 9	T70 / 70 / 9	T70 / 70 / 9	T70 / 70 / 9	T70 / 70 / 9	T70 / 70 / 9
Shaft enclosure	Concrete	Concrete	Concrete	Concrete	Concrete	Concrete

NOTES:

(1) The values included in this table correspond to pre-established conditions and may be modified, according to the specific characteristics of each installation.

(2) Current data for 400 V mains voltage. Optional single-phase power voltage at 230 V.

(3) With compensatory safety measures / Without compensatory safety measures / Economical option / Loft option. Dimensions of Pit and Headroom with automatic landing doors, MASSEN model.

LEGEND AH Shaft width FH Shaft depth AC Car width HC Car height FC Car depth OH Headroom F Pit PL Standard clear opening R Travel range

